

VALVES

PLANT VALVES

VG8000N

DN15...150, PN16

These electrically and pneumatically operated flanged valves are primarily designed to regulate the flow of water and steam in response to the demand of a controller in Heating, Ventilating and Air Conditioning (HVAC) systems.

A variety of electric and pneumatic actuators are available.



FEATURES

- Nodular cast iron body
- K_{VS} 0.1...350
- 2-way PDTC (normally open), 3-way mixing and 3-way diverting configurations
- Fluid temperature 0...180°C with Glycerine cup -10...180°C
- DIN flanged

DIMENSIONS (in mm)

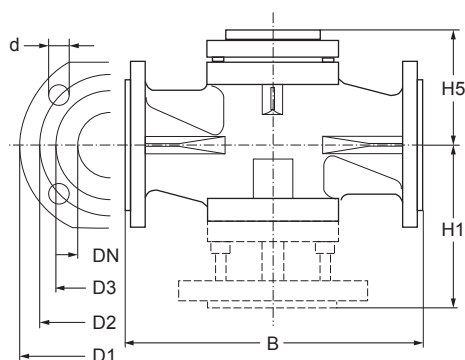

BODY SIZE	B	D1	D2	D3	D	H1	H5	BOLTS	HOLES
DN15	130	95	65	45	13.5	100	76	M12 x 45	4
DN20	150	105	75	58	13.5	106	76	M12 x 50	4
DN25	160	115	85	68	13.5	106	76	M12 x 50	4
DN32	180	140	100	78	17.5	123	81	M16 x 55	4
DN40	200	150	110	88	17.5	140	78	M16 x 55	4
DN50	230	165	125	102	17.5	145	101	M16 x 60	4
DN65	290	185	145	122	17.5	156	102	M16 x 60	4
DN80	310	200	160	138	17.5	180	108	M16 x 65	8
DN100	350	220	180	158	17.5	225	136	M16 x 70	8
DN125	400	250	210	188	17.5	255	155	M16 x 75	8
DN150	480	285	240	212	22	290	175	M20 x 75	8

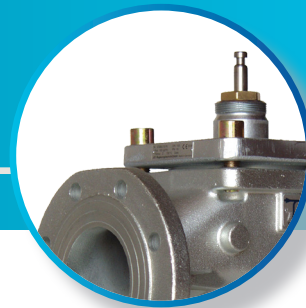

VALVES

VG8000N - PLANT VALVES

ORDERING INFORMATION

2-WAY PDTC (NORMALLY OPEN) CONFIGURATION

CODES *	BODY SIZE	K _{VS}	CLOSE-OFF PRESSURE kPa						
			FA-2000-741x 2400 N	FA-2000-751x 2200 N	FA-3300 6000 N	RA-3100-8226 2700 N	VA1x20 ** 2000 N	VA1125 ** 2500 N	VA78xx 1000 N
VG82A4S1N	DN15	1.0	---	---	---	---	1600	1600	1600
VG82A3S1N		1.6							
VG82A2S1N		2.5							
VG82A1S1N		4.0							
VG82B1S1N	DN20	6.3	---	---	---	650	800	1080	---
VG82C1S1N	DN25	10							
VG82D1S1N	DN32	16							
VG82E1S1N	DN40	25							
VG82F1S1N	DN50	40	1030	790	370	220	380	390	---
VG82G1S1N	DN65	63							
VG82H1S1N	DN80	100							
VG82J1S1N	DN100	160							
VG82K1S1N	DN125	250	190	---	740	120	160	230	---
VG82L1S1N	DN150	350							
			110	---	460	---	90	140	
			50	---	280	---	40	75	

Notes

* For factory mounted valve actuators just add "+M" to the actuator ordering code
 For ordering a valve with Glycerine cup packing, add suffix "20" to the ordering code: i.e. VG8xxxS1H20.
 Teflon free model are available on request.

** For fluid temperature >140°C the extension kit VA1000-EP must be mounted.

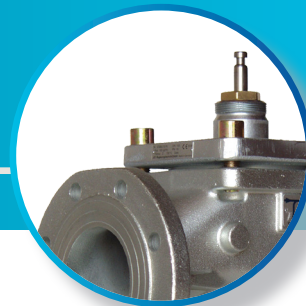

ORDERING INFORMATION

3-WAY MIXING CONFIGURATION

CODES *	BODY SIZE	K _{VS}	CLOSE-OFF PRESSURE kPa						
			FA-2000-741x 2400 N	FA-2000-751x 2200 N	FA-3300 6000 N	RA-3100-8226 2700 N	VA1x20 ** 2000 N	VA1125 ** 2500 N	VA78xx 1000 N
VG88A4S1N	DN15	1.0	---	---	---	---	1600	1600	1600
VG88A3S1N		1.6							
VG88A2S1N		2.5							
VG88A1S1N		4.0							
VG88B1S1N	DN20	6.3	---	---	---	650	800	1080	---
VG88C1S1N	DN25	10							
VG88D1S1N	DN32	16							
VG88E1S1N	DN40	25							
VG88F1S1N	DN50	40	---	---	---	500	630	830	---
VG88G1S1N	DN65	63							
VG88H1S1N	DN80	100							
VG88J1S1N	DN100	160							
VG88K1S1N	DN125	250	---	---	---	---	90	140	---
VG88L1S1N	DN150	350							
			190		740	120	160	230	
			110		460				
			50		280		40	75	

Notes

- * For factory mounted valve actuators just add "+M" to the actuator ordering code
For ordering a valve with Glycerine cup packing, add suffix "20" to the ordering code: i.e. VG8xxxS1H20.
Teflon free model are available on request.

- ** For fluid temperature >140°C the extension kit VA1000-EP must be mounted.

VG8000N - PLANT VALVES

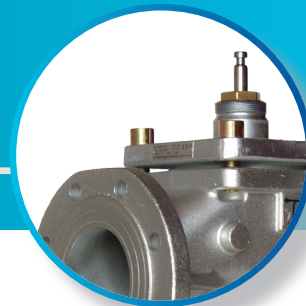

ORDERING INFORMATION

3-WAY MIXING CONFIGURATION

CODES *	BODY SIZE	K _{VS}	CLOSE-OFF PRESSURE kPa						
			FA-2000-741x 2400 N	FA-2000-751x 2200 N	FA-3300 6000 N	RA-3100- 8226 2700 N	VA1x20 ** 2000 N	VA1125 ** 2500 N	VA78xx 1000 N
VG89A4S1N	DN15	1.0	---	---	---	---	1600	1600	1600
VG89A3S1N		1.6							
VG89A2S1N		2.5							
VG89A1S1N		4.0							
VG89B1S1N	DN20	6.3	---	---	---	1600	1600	1600	---
VG89C1S1N	DN25	10							
VG89D1S1N	DN32	16							
VG89E1S1N	DN40	25							
VG89F1S1N	DN50	40	---	---	---	1600	1600	1600	---
VG89G1S1N	DN65	63							
VG89H1S1N	DN80	100							
VG89J1S1N	DN100	160							
VG89K1S1N	DN125	250	---	---	---	1600	1600	1600	---
VG89L1S1N	DN150	350							

Notes

* For factory mounted valve actuators just add "+M" to the actuator ordering code
For ordering a valve with Glycerine cup packing, add suffix "20" to the ordering code: i.e. VG8xxxS1H20.
Teflon free model are available on request.

** For fluid temperature >140°C the extension kit VA1000-EP must be mounted.